

ANACONDA MULTIFLEX

CONDUIT TYPE SLI



Multiflex SLI: Flexible & extra corrosion resistant.

The SLI is made of stainless steel and is being applied when chemical and mechanical protection is needed, high temperatures are involved, and water-tightness is not required. The application fields are steelworks and aluminium foundries, navy and shipbuilding industry.

Material & Construction:

Construction: Stainless steel (AISI-304) core, square-locked.

Temperature: -100 °C to +600 °C.

Colour: Metal coloured.



Classification according NEN-EN-IEC 61386:

Compression resistance: Class 4, Heavy (1250 N).

Impact resistance: Class 4, Heavy (6 J).

Tensile strength: Class 4, Heavy (1000 N).

Protection class: IP 40.



Square locked

SLI	Diametre		Bending radius		Standard carton		Small carton		Reels		Weight (Kg/m)
	Size (Inch)	Inside (mm)	Outside (mm)	Static (mm)	Dynamic (mm)	Metre	Article No.	Metre	Article No.	Metre	
5/16"	10,1	12,8	50	65	30	600.010.2	-	-	-	-	-
3/8"	12,6	15,5	60	85	30	600.012.2	-	-	-	-	-
1/2"	16,0	18,9	75	110	30	600.016.2	-	-	-	-	-
3/4"	21,0	23,9	90	140	30	600.020.2	-	-	-	-	-
1"	26,5	30,0	120	170	30	600.026.2	-	-	-	-	-
1.1/4"	35,1	38,7	135	215	30	600.035.2	-	-	-	-	-

* For sizes 1.1/2" and bigger it is advised to use the fully inter-locked product type UI (see page 1-12).

The fittings for Multiflex SLI are outlined on pages 1-04 and 1-05.



Size SLI	Inch	1/4"	5/16"	3/8"	1/2"	3/4"	1"	1 1/4"	1 1/2"	2"	2 1/2"	3"	4"
Fittings	ISO	M12-M16	M16-M20	M16-M20	M20	M25	M32	M40	M50	M63	M75	M90	M105
	PG	7	9 - 11	11 - 13,5	16	21	29	36	42	48	-	-	-
	NPT	-	-	1/2"	1/2"	3/4"	1"	1 1/4"	1 1/2"	2"	2 1/2"	3"	4"



Anaconda nickel plated brass fittings for Multiflex SL / SLI.

The nickel plated brass Anaconda fittings can be used with all types of Anaconda Multiflex (except RWA). This Anaconda fitting is the most used universal fitting and offers great corrosion protection in combination with a nice appearance. By using the SL/SLI connection set consisting of a special turned ferrule and clamping ring, a very high pull-out strength is achieved. Besides the mentioned straight fittings also 45° and 90° fittings are possible. The connection set can be combined with all types of Anaconda fittings both nickel plated brass and stainless steel (see chapter 4 & 6). The connection set will be supplied separately.

Material & Construction:

Construction: Nickel plated brass fitting, consisting of 4 parts (counter nut, clamping ring, ferrule and body).

Material: Counter nut, clamping ring, ferrule and body are nickel plated brass. Inserts are from PA6 (red for ISO metric, blue for Pg and white for NPT).

Temperature: -55 °C till +260 °C continuous.

Protection class: IP 40, (cable-hose fittings are IP 68 on the switchbox).

Colour: Metal.

Connection set, nickel plated brass, for combination with Multiflex type SL / SLI.



Thread	SL/SLI	Min. Internal Bore (mm)	Fitting thread size			Standard Package	Article Number	Weight (Kg/100)
	Size (inch)		ISO	Pg	NPT			
-	5/16"	8,3	M16 x 1,5	Pg 9	1/2" NPT	50	817.210.6*	-
-	3/8"	10,2	M16 x 1,5	Pg 11	1/2" NPT	50	817.312.6	-
-	1/2"	13,6	M20 x 1,5	Pg 16	1/2" NPT	50	817.316.6	-
-	3/4"	18,5	M25 x 1,5	Pg 21	3/4" NPT	25	817.320.6	-
-	1"	23,8	M32 x 1,5	Pg 29	1" NPT	10	817.326.6	-
-	1.1/4"	31,8	M40 x 1,5	Pg 36	1.1/4" NPT	5	817.235.6*	-

* Set consists of a clamping ring only.

ISO straight fitting, male, nickel plated brass (including connection set).

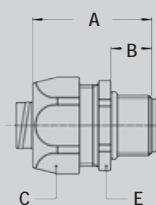

Thread ISO	SL/SLI	Min. Internal Bore (mm)	Dimensions in mm					Standard Package	Article Number	Weight (Kg/100)
	Size (inch)		A	B	C	D	E			
M16 x 1,5	5/16"	8,3	35	12	26	-	24	50	812.015.6	4,8
M20 x 1,5	5/16"	8,3	36	13	26	-	24	50	812.014.6	5,1
M16 x 1,5	3/8"	10,2	35	12	26	-	24	50	812.016.6	4,8
M20 x 1,5	3/8"	10,2	36	13	26	-	24	50	812.017.6	5,1
M20 x 1,5	1/2"	13,6	37	13	29	-	27	50	812.020.6	5,9
M25 x 1,5	3/4"	18,5	40	15	35	-	33	25	812.025.6	7,9
M32 x 1,5	1"	23,8	46	15	45	-	43	10	812.032.6	17,5
M40 x 1,5	1.1/4"	31,8	52	16	54	-	52	5	812.040.6	27,9

ISO straight fitting, female, nickel plated brass
(including connection set).

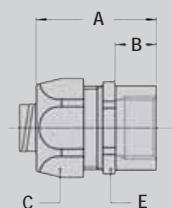

Thread	SL/SLI Size (inch)	Min. Internal Bore (mm)	Dimensions in mm					Standard Package	Article Number	Weight (Kg/100)
			A	B	C	D	E			
M16 x 1,5	5/16"	8,3	35	12	26	-	24	50	812.315.6	5,0
M16 x 1,5	3/8"	10,2	35	12	26	-	24	50	812.316.6	5,0
M20 x 1,5	1/2"	13,6	37	13	29	-	27	50	812.320.6	7,6
M25 x 1,5	3/4"	18,5	40	15	35	-	33	25	812.325.6	9,0
M32 x 1,5	1"	23,8	46	15	45	-	43	10	812.332.6	18,3
M40 x 1,5	1.1/4"	31,8	52	16	54	-	52	5	812.340.6	31,8

ISO straight swivel fitting, male, nickel plated brass
(including connection set).

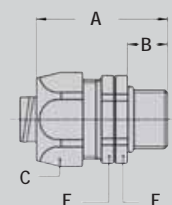

Thread	SL/SLI Size (inch)	Min. Internal Bore (mm)	Dimensions in mm					Standard Package	Article Number	Weight (Kg/100)
			A	B	C	D	E			
M16 x 1,5	5/16"	8,3	41	12	26	-	24	50	813.015.6	6,8
M16 x 1,5	3/8"	10,2	41	12	26	-	24	50	813.016.6	6,8
M20 x 1,5	1/2"	13,6	43	13	29	-	27	50	813.020.6	8,6
M25 x 1,5	3/4"	18,5	48	15	35	-	33	25	813.025.6	11,6
M32 x 1,5	1"	23,8	54	15	45	-	43	10	813.032.6	27,6
M40 x 1,5	1.1/4"	31,8	-	-	-	-	-	5	813.040.6	-

ISO cable-hose fitting, male, nickel plated brass
(including connection set).

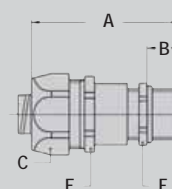

Thread	SL/SLI Size (inch)	Clamping Range (mm)	Dimensions in mm					Standard Package	Article Number	Weight (Kg/100)
			A	B	C	E	F			
M16 x 1,5	5/16"	4 - 8	57	12	26	24	18	25	812.715.6	7,6
M16 x 1,5	3/8"	4 - 8	57	12	26	24	18	25	812.716.6	7,8
M20 x 1,5	3/8"	6 - 10,2	57	12	26	24	22	25	812.717.6	9,5
M20 x 1,5	1/2"	6 - 12	59	12	29	27	22	25	812.720.6	9,7
M25 x 1,5	1/2"	10 - 13,6	62	12	29	27	27	25	812.722.6	11,7
M32 x 1,5	3/4"	13 - 18	70	15	35	33	34	25	812.728.6	19,6
M40 x 1,5	1"	18 - 23,8	83	15	45	43	43	10	812.735.6	35,4

Pg straight fitting, male, nickel plated brass
(including connection set).

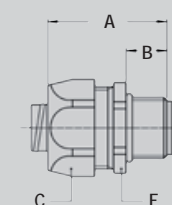

Thread	SL/SLI Size (inch)	Min. Internal Bore (mm)	Dimensions in mm					Standard Package	Article Number	Weight (Kg/100)
			A	B	C	D	E			
Pg 9	5/16"	8,3	35	12	26	-	24	50	810.009.6	4,8
Pg 11	5/16"	8,3	35	12	26	-	24	50	810.012.6	5,6
Pg 9	3/8"	10,2	35	12	26	-	24	50	810.010.6	4,8
Pg 11	3/8"	10,2	35	12	26	-	24	50	810.011.6	5,6
Pg 13,5	3/8"	10,2	35	12	26	-	24	50	810.013.6	5,6
Pg 16	1/2"	13,6	37	13	29	-	27	50	810.016.6	6,3
Pg 21	3/4"	18,5	40	15	35	-	33	25	810.021.6	8,4
Pg 29	1"	23,8	46	15	45	-	43	10	810.029.6	25,0
Pg 36	1.1/4"	31,8	52	16	54	-	52	5	810.036.6	34,6

ANACONDA
MULTIFLEX

FITTINGS FOR
TYPE SL / SLI
IP 40